



DEPARTMENT OF COMMUNITY DEVELOPMENT SERVICES

Economic Development Division

m e m o r a n d u m

TO: Bruce Walden, Chief Administrative Officer

FROM: Elizabeth H. Tyler, AICP, Director

DATE: May 22, 2002

**SUBJECT: Motion Directing City Clerk to Publish Notice
(Beringer Commons Involuntary Annexations)**

Description

Staff is requesting the City Council to approve the attached motion directing the City Clerk to publish the attached Notice of Annexation. The notice is required by State statute to advise affected property owners, residents, and the general public, that the City of Urbana will consider an ordinance on June 17, 2002 causing the annexation of eleven unincorporated properties that are completely surrounded by the City of Urbana's corporate boundaries. A map is attached showing the location of the lots proposed to be annexed.

Background

An annexation agreement between the City of Urbana and the developer of Beringer Commons Subdivision was approved and authorized by City Council on August 5, 1991 (Council Ordinance No. 9192-20). The agreement required that these properties be annexed into the City in 1999.

Issues & Approvals

While some owners have agreed to comply with the annexation agreement, several property owners have refused or ignored the City's request to annex. Staff intends to annex all property in Beringer Commons Subdivision before July 1, 2002 to enforce the terms of the annexation agreement. If annexations do not take effect until or after July 1, 2002, it will mean another year that a few individuals not only continue to violate the terms of the annexation agreement, but also avoid another year of paying City property taxes, whereas the majority of the property owners in Beringer Commons have complied with the agreement.

If the Council approves the motion contemplating annexation, then staff will contact the property owners regarding the cost and benefits associated with annexation and initiate appropriate notice to affected property owners, residents, and taxing districts.

Options

Council's options include approving the motion as presented herein; to suggest specific changes or modifications; or to decline to make such a motion.

Fiscal Impact

The eleven properties proposed to be annexed have a combined assessed valuation of nearly \$600,000.

Recommendation

Staff recommends that City Council approve the attached motion directing the City Clerk to publish notice of the proposed annexation.

Prepared by: _____
Reed Berger, AICP, Economic Development Coordinator

Attachments: Notice of Annexation
Motion & Location Map

c: Mayor Satterthwaite and City Council Members
City Department Heads

NOTICE OF ANNEXATION

Pursuant to the Illinois Municipal Code (65 ILCS 5/7-1-13) , notice is hereby given that the annexation of the territory described below is contemplated by the Corporate Authorities of the City of Urbana, Illinois, and that they propose to consider and take action on an ordinance annexing such territory at a regular meeting of the Urbana City Council on Monday, June 17, 2002 at 7:30 p.m in the City Council Chambers of the City Building, 400 South Vine Street, Urbana, Illinois.

Lot 221 of Beringer Commons Subdivision No. 2a, Urbana Township, Champaign County, Illinois, per plat recorded in Plat Book CC at page 30, in the Office of the Recorder, Champaign County, Illinois. Situated in Champaign County, Illinois and containing 0.2944 Acre, more or less.

Commonly known for reference as 412 N. Abbey Road and also identified as Parcel Index Number 30-21-10-402-016.

and

Lot 220 of Beringer Commons Subdivision No. 2b, Urbana Township, Champaign County, Illinois, per plat recorded in Plat Book CC at page 63, in the Office of the Recorder, Champaign County, Illinois. Situated in Champaign County, Illinois and containing 0.2946 Acre, more or less.

Commonly known for reference as 414 N. Abbey Road and also identified as Parcel Index Number 30-21-10-402-017.

and

Lot 219 of Beringer Commons Subdivision No. 2b, Urbana Township, Champaign County, Illinois, per plat recorded in Plat Book CC at page 63, in the Office of the Recorder, Champaign County, Illinois. Situated in Champaign County, Illinois and containing 0.3673 Acre, more or less.

Commonly known for reference as 2803 Slayback Street and also identified as Parcel Index Number 30-21-10-402-018.

and

Lot 218 of Beringer Commons Subdivision No. 2b, Urbana Township, Champaign County, Illinois, per plat recorded in Plat Book CC at page 63, in the Office of the Recorder, Champaign County, Illinois. Situated in Champaign County, Illinois and containing 0.2571 Acre, more or less.

Commonly known for reference as 2805 Slayback Street and also identified as Parcel Index Number 30-21-10-402-019.

and

Lot 215 of Beringer Commons Subdivision No. 2b, Urbana Township, Champaign County, Illinois, per plat recorded in Plat Book CC at page 63, in the Office of the Recorder, Champaign County, Illinois. Situated in Champaign County, Illinois and containing 0.3205 Acre, more or less.

Commonly known for reference as 2811 Slayback Street and also identified as Parcel Index Number 30-21-10-402-022.

and

Lot 232 of Beringer Commons Subdivision No. 2b, Urbana Township, Champaign County, Illinois, per plat recorded in Plat Book CC at page 63, in the Office of the Recorder, Champaign County, Illinois. Situated in Champaign County, Illinois and containing 0.2944 Acre, more or less.

Commonly known for reference as 504 N. Abbey Road and also identified as Parcel Index Number 30-21-10-404-001.

and

Lot 233 of Beringer Commons Subdivision No. 2b, Urbana Township, Champaign County, Illinois, per plat recorded in Plat Book CC at page 63, in the Office of the Recorder, Champaign County, Illinois. Situated in Champaign County, Illinois and containing 0.3223 Acre, more or less.

Commonly known for reference as 2802 Slayback Street and also identified as Parcel Index Number 30-21-10-404-002.

and

Lot 234 of Beringer Commons Subdivision No. 2b, Urbana Township, Champaign County, Illinois, per plat recorded in Plat Book CC at page 63, in the Office of the Recorder, Champaign County, Illinois. Situated in Champaign County, Illinois and containing 0.2777 Acre, more or less.

Commonly known for reference as 2804 Slayback Street and also identified as Parcel Index Number 30-21-10-404-003.

and

Lot 237 of Beringer Commons Subdivision No. 2b, Urbana Township, Champaign County, Illinois, per plat recorded in Plat Book CC at page 63, in the Office of the Recorder, Champaign County, Illinois. Situated in Champaign County, Illinois and containing 0.2605 Acre, more or less.

Commonly known for reference as 2810 Slayback Street and also identified as Parcel Index Number 30-21-10-404-006.

and

Lot 238 of Beringer Commons Subdivision No. 2b, Urbana Township, Champaign County, Illinois, per plat recorded in Plat Book CC at page 63, in the Office of the Recorder, Champaign County, Illinois. Situated in Champaign County, Illinois and containing 0.3760 Acre, more or less.

Commonly known for reference as 2812 Slayback Street and also identified as Parcel Index Number 30-21-10-404-007.

and

A commons area of Beringer Commons Subdivision No. 2b, Urbana Township, Champaign County, Illinois, per plat recorded in Plat Book CC at page 63, in the Office of the Recorder, Champaign County, Illinois. Situated in Champaign County, Illinois and containing 0.7039 Acre, more or less.

Commonly known for reference as Parcel Index Number 30-21-10-404-008.

Together with the adjacent unincorporated public Rights-of-Way, which are by operation of the law automatically annexed with the adoption of an Annexation Ordinance pertaining to these parcels.

Questions regarding the proposed annexations should be directed to Reed Berger, Economic Development Coordinator (phone 217-384-2442) or email raberger@city.urbana.il.us.

Phyllis D. Clark, City Clerk

A MOTION TO PUBLISH NOTICE OF A PROPOSED INVOLUNTARY ANNEXATION OF TERRITORY LOCATED IN BERINGER COMMONS SUBDIVISION

“I move that the City Clerk be directed to cause a notice to be published in the News Gazette newspaper advising that annexation of unincorporated territory which is presently wholly surrounded by the City of Urbana and located within Beringer Commons Subdivision is under contemplation by this Council.”

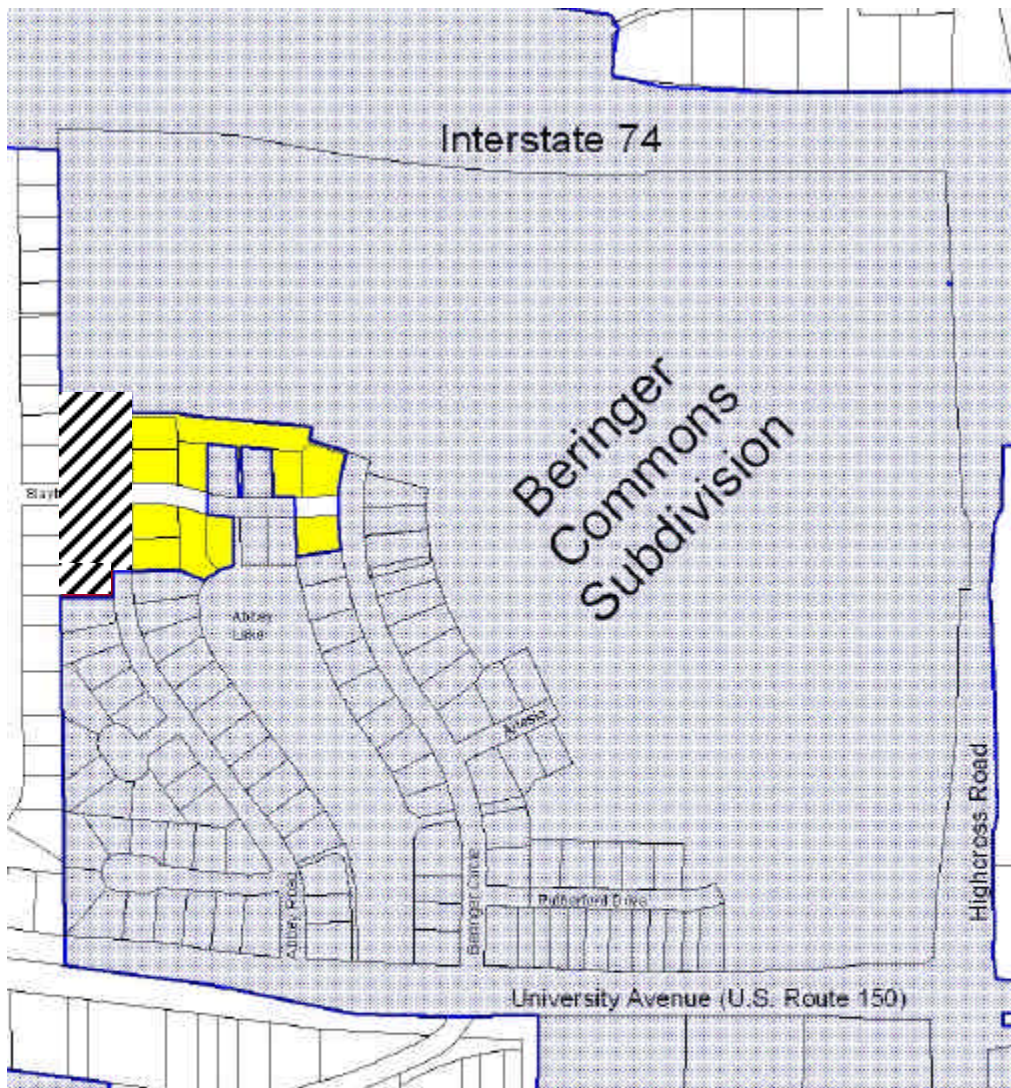

Beringer Commons Voluntary Annexations

-  Territory annexed May 30, 2002
-  Territory to be surrounded May 30, 2002 and annexed June 27, 2002

prepared May 8, 2002 by Community Development Services - RAB

